

Subject Slave Piston Seal Ring Kit

Part Number
P60157

Engine Application
Detroit S60

Fits Models
**Pacbrake
P-63C Only**

Attention: Sealing ring pistons are designed to stop oil by-pass in bores and are unable to prevent damage due to piston misalignment if excessive wear present. This kit is not for use on P-63A and P-63B housings.

Installation Instructions

REMOVAL OF THE HOUSINGS FROM THE ENGINE

1. Thoroughly clean the engine around the valve cover and remove. Check the gasket and replace if necessary. Two piece cover remove only the top.
2. Mark the housings position 1, 2 and 3 so they can be installed in their original position on the engine.
3. Disconnect the wires from the solenoids.
4. Loosen the slave adjusting screw lock-nuts.
5. Loosen and remove the hold down capscrews, lift the housings from the engine.

DISASSEMBLY AND ASSEMBLY OF THE BRAKE HOUSINGS

1. Place the housings (in order) on a clean work bench.
Important Note: when removing all parts keep them in order of their original location for installation later.
2. Remove the slave piston adjusting screws, inspect the plungers for spring pressure.
Note: Detroit Diesel released a revised injector retainer for Series 50 and Series 60 engines. This revised injector retainer created a clearance issue with the Pacbrake slave piston shoulder bolt. Consult service Bulletin #154. Now would be the opportune time to install an injector retainer retro fit kit for P-63C order PN P63013.
3. **Slave Piston Removal**
Remove the capscrews which fasten the slave piston bridge and springs to the housing. Remove the slave piston bridges, springs and slave pistons. Discard the slave pistons only.
4. Apply clean engine oil to the replacement pistons and rings and install in housing bores.
5. Reinstall bridge retainer washers, slave springs and stepped washers (step facing towards spring).
Damage will occur if washers are installed incorrectly!
6. **Apply 242 Loctite to threads of shoulder bolts and torque to 100 lbs. in.** Check that shoulder bolt is installed to machined surface. If a gap exists between the machined surface and the bolt's shoulder, remove and insert a 1/4 - 20 NC tap to clean the threads.
7. Reinstall slave piston adjusting screws and install housings on the engine as per Pacbrake Installation Manual.

Installation PROCEDURES

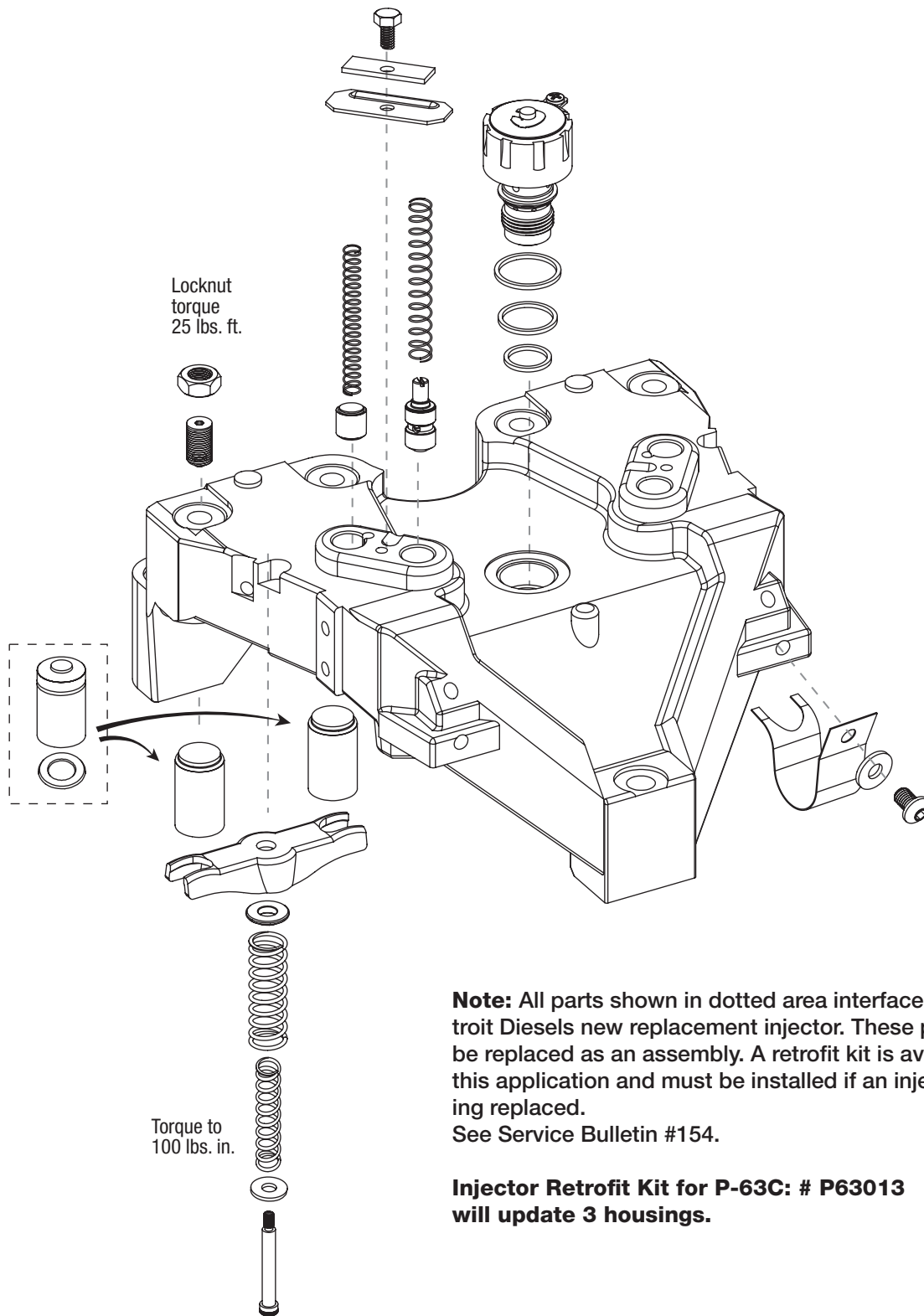

Note: All parts shown in dotted area interface with Detroit Diesels new replacement injector. These parts must be replaced as an assembly. A retrofit kit is available for this application and must be installed if an injector is being replaced.
See Service Bulletin #154.

Injector Retrofit Kit for P-63C: # P63013
will update 3 housings.