

# Service

## BULLETIN #159

MARCH 20 2003

PAGE 1/1

MODELS AFFECTED

**P-39/P-39A/P39B**

SUBJECT

**RELEASE OF NEW CONTROL VALVE AND INNER CONTROL VALVE SPRING COMBINATION**

**Pacbrake has released a new control valve and inner control valve spring combination for all P-39/P-39A/P-39B engine brakes.**

The control valve part number P01500 replaces the previously used part number P11930 and will be used with the inner control valve spring part number P11435. The outer control valve spring remains unchanged for all applications. The new parts are available through the Pacbrake distribution system, but existing stock of original control valve and springs can be used until stock is depleted. If updating an engine brake to a new combination, it is imperative all cylinders are done. It is not recommended to interchange the new and old combinations in the same engine brake.

P-39A engine brakes Serial # 070725 and later contain the new spring and control valve combination.

P-39B engine brakes Serial # 101479 and later contain the new spring and control valve combination.

This is a product improvement not subject to campaign.

Old Combination      New Combination

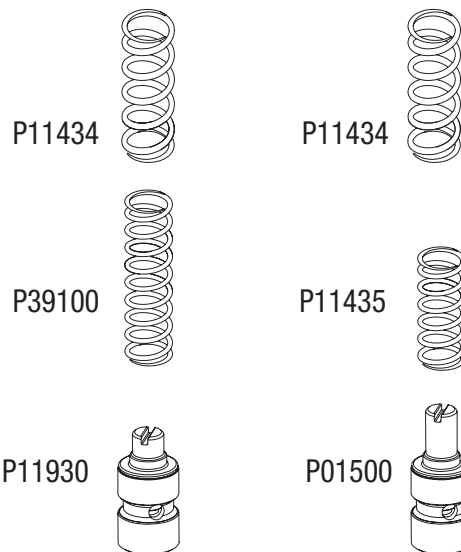

**Pacbrake** Service

**PACBRAKE**<sup>®</sup>  
ENGINE & EXHAUST BRAKES